



Inductive Probes

A wide range of Half Bridge gauging probes





The Half Bridge or LVDT inductive probes technology has been known for over 100 years and enables to offer a products range covering most of the needs in dimensional control.

Materials used to manufacture our probes leads to an unqualified robustness and longevity.

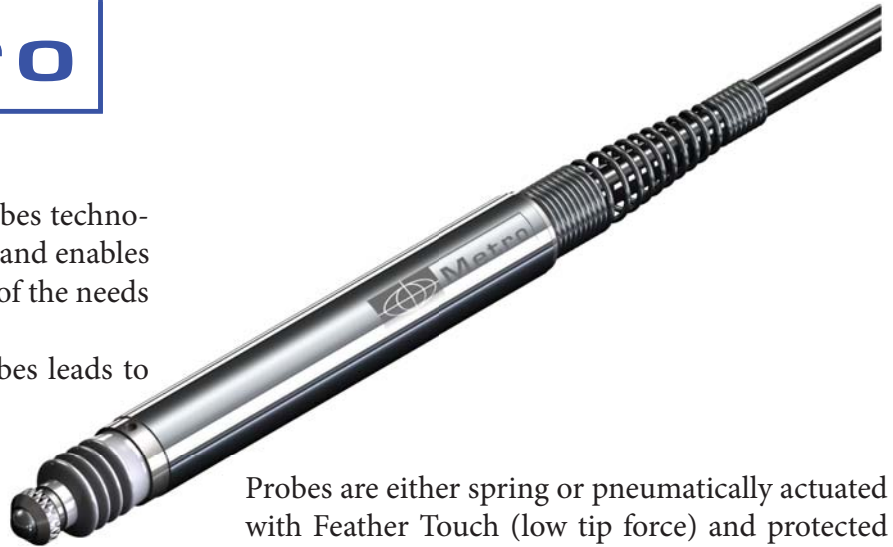

Probes are either spring or pneumatically actuated with Feather Touch (low tip force) and protected cable (stainless steel sheath) variants available.

Spring Push or Pneumatic actuation

In a conventional 'pencil' probe the tip pushes outwards under the influence of an internal spring. When installed in a fixture it is frequently required to design a mechanism to bring the probe into contact with the piece part being gauged.

In contrast, pneumatic operation allows the number of moving parts in a fixture to be reduced, resulting in improved reliability and reduced fixture costs. It also enables fast and safe automatic loading of components into a gauge when required.

Feather Touch Probes

Feather Touch probes have been designed especially to gauge delicate surfaces such as car windcreens, TV tubes, pharmaceutical bottles, electro-mechanical components and plastic parts. Whereas a traditional probe exerts a tip force of approximately 0.7N, the Feather Touch exerts a mere 0.18N when used in the horizontal position. This reduction is achieved by replacing the naturally elastic traditional gaiter with a close tolerance gland. On pneumatic versions the air leakage through the gland is restricted to less than 2.5 millilitres per second at 1 bar to minimise the possibility of contamination to the surface being gauged. Despite the low volume of air flow the bearing within the probe is constantly purged, avoiding the build up of dust (use of filtered air is recommended).

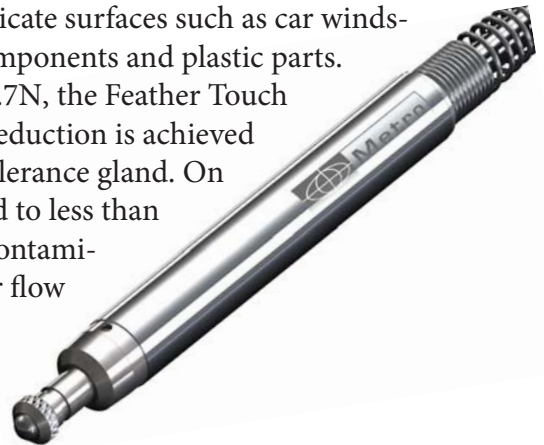

Optional Protected cable

As an option we can deliver our probes ref M802 and M804 with a cable protected by a stainless steel sheath.

Environmental protection

Our probes are all fitted with Viton® gaiters to exclude moisture and dust.

Viton® is chemically inert and does not degrade when subjected to cutting fluids.

Probes with the Feather Touch option have glands instead of gaiters, and therefore should only be used in a dry environment.

All gauging transducer cables feature a 2m polyurethane (PUR) sheath with a foil screen layer for better electrical screening. Improved mechanical properties include reduced 'memory' effect and superior resistance to scuffs and cuts.

Spring Push



Product type	M801	M802(A)	M804(A)	ME810	ME820
Measurement range (mm)	± 0.5	± 1	± 2	± 5	± 10
Pre-travel (mm)	0.15	0.15	0.15	0.15	0.15
Post- travel (mm)	0.35	0.35	0.85	0.85	0.85
Repeatability (µm)	<0.15	<0.15	<0.15	<0.15	<0.15
Accuracy (% of reading)	0.3%	0.3%	0.3%	0.3%	0.3%
Tip force (N) : Standard	0.7	0.7	0.7	0.7	0.7
Tip force (N) : Feather touch (T suffix)	-	0.3	0.3	0.3	-
Operating Temp. °C	+5 +80	+5 +80	+5 +80	+5 +80	+5 +80
Gaiter	Viton °	Viton °	Viton °	Viton °	Viton °
Cable	2m PUR	2m PUR	2m PUR	2m PUR	2m PUR
Body diameter	8h6	8h6	8h6	8h6	8h6
IP rating	IP65	IP65	IP65	IP65	IP65
Standard product ref	80001	80002	80003	80004	80005
Feather touch product ref (T suffix)	-	80022	80023	80024	80025
Armoured product ref (A suffix)	-	80202	80203	-	-

Pneumatic



Product type	M802/P	M804/P	M810/P	ME810-2/P	ME820/P
Measurement range (mm)	± 1	± 2	± 5	± 1	± 10
Pre-travel (mm)	0.15	0.15	0.15	0.15	0.15
Post- travel (mm)	0.35	0.35	0.85	0.85	0.85
Repeatability (µm)	<0.15	<0.15	<0.15	<0.15	<0.15
Accuracy (% of reading)	0.3%	0.3%	0.3%	0.3%	0.3%
Tip force (N@0,4 / 1bar)	0.8 / 2.8	0.85 / 2.5	0.85 / 2.5	0.85 / 2.5	0.85 / 2.5
Operating Temp. °C	+5 +80	+5 +80	+5 +80	+5 +80	+5 +80
Gaiter	Viton °	Viton °	Viton °	Viton °	Viton °
Cable	2m PUR	2m PUR	2m PUR	2m PUR	2m PUR
Body diameter	8h6	8h6	8h6	8h6	8h6
IP rating	IP65	IP65	IP65	IP65	IP65
Standard product ref	80102	80103	80104	80114	80105
Feather touch product ref (T suffix)	80122	80122	80124	-	80125

Accessories and spare parts

Extension cables :

Cable extension can be used to increase the distance from the probe to the measuring device. Our standard version is a 2m cable. Others length are available on demand.

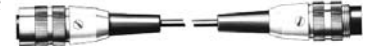

Gaiters :

Replacement gaiters for analogue and digital gauging probes and linear encoders. Gaiters are in Viton that is chemically inert and does not degrade when subjected to cutting fluids.

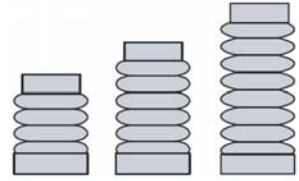

Springs :

Replacement springs for analogue gauging probes



Mechanical dimensions

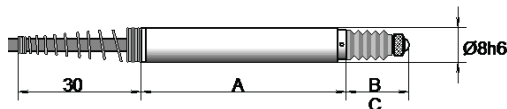
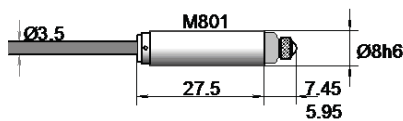

Standard Spring push

	M802 (A)	M804 (A)	M810	ME820
A	46	57	91	133
B	11.4	11.4	14.4	21.4
C	13.4	17.4	25.4	42.4

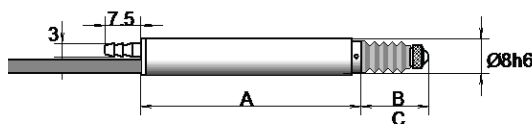

Standard Pneumatic

	M802P	M804P	M810P	ME810-2P	ME820P
A	55.5	77.5	102.5	102.5	136.5
B	10.9	11.4	14.4	14.4	21.5
C	13.9	17.4	25.4	25.4	42.5

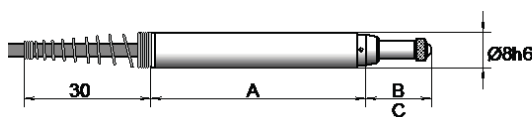

Feather touch / spring push

	M802T	M804T	M810T	ME820T
A	46	68	91	134
B	11.4	11.4	14.4	12.9
C	13.9	17.4	25.4	33.9

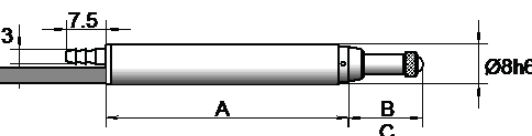

Feather touch / pneumatic

	M802TP	M804TP	M810TP	ME820TP
A	55.5	77.5	102.5	136.5
B	10.9	11.4	14.4	21.5
C	13.9	17.4	25.4	42.5



Metro
Rue de la Jonchère
74420 Boège
France
Tel. +33(0)4-50-39-08-49
Fax. +33(0)4-50-39-08-33
E-mail : info@metro-fr.com
Web : http://www.metro-fr.com

Your distributor

IMTS
ITALIA

ugf g"qr gtcvxc<
Via Brandizzo 133/b
322: : "Xqqr kcpq"*Vq+

IO VU'K/CNK"UTN

233"3; : "5; "269
557"376": 442
lphqB ko vitalia.it

CIEN1000212